

# Klappgerüst

BGR 173/04.00 (ZH 1/534.8)

Kleingerüst

# 70068/10

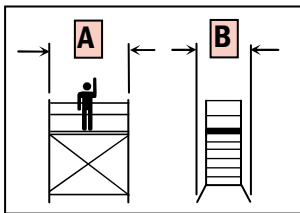

<b>A x B</b>
1,41 m x 0,69 m

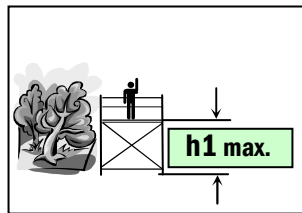

<b>h1 max.</b>
0,90 m

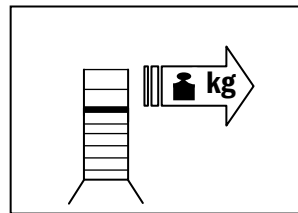

<b>Max.</b>
30 kg (0,3 kN)

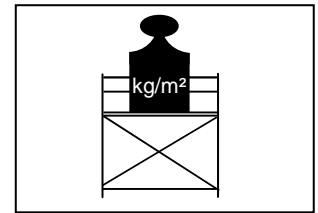

<b>Max.</b>
150 kg/m <sup>2</sup> (1,5 kN/m <sup>2</sup> )

**Foldable Scaffold**  
**Echafaudage pliant**  
**Vouwsteiger**  
**Andamio Plegable**  
**Andaimes dobrando**



- (D)** Aufbau- und Gebrauchsanweisung
- (GB)** Instructions for use and construction
- (F)** Instructions de montage et d'utilisation
- (NL)** Opbouw- en gebruiksaanwijzing
- (E)** Manual del Propietario
- (PT)** Insrtuções de montagem e de utilização

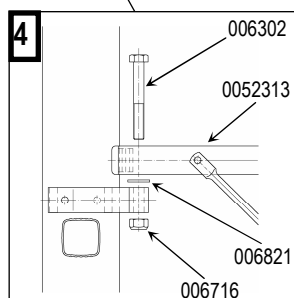
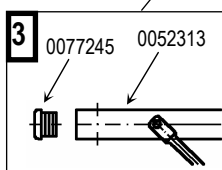
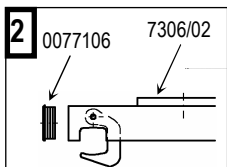
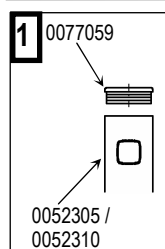

**Einzelelemente/Stückliste partlist Pièces détachées especificación onderdelen/stuklijst**

70068/10			
Nr.		kg	Stk
0052305		2,5	1
0052310		2,5	1
7306/02		5,4	1
0052313		1,5	1
70068/52			1
	<b>kg</b>		11,9

70068/52			
Nr.			Stk
006302		M8 x 55	4
006821		A 8,4	4
006716		M8	4
0077059		60 x 25	4
0077106		40 x 20	4
0077245		22 x 22	4
0095597			1