

## Combination ladder, two-section 4045

- Versatile combination freestanding and extension ladder for numerous areas of application.
- Rolled profile rungs.
- High-quality plastic rounded ladder feet pressed into stile.
- Flexible use thanks to comprehensive accessories.
- Safety locking device made of two high-strength nylon straps when used as a freestanding ladder.
- Stabiliser bar.

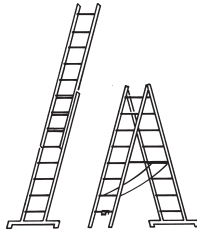

### Recommended accessories:

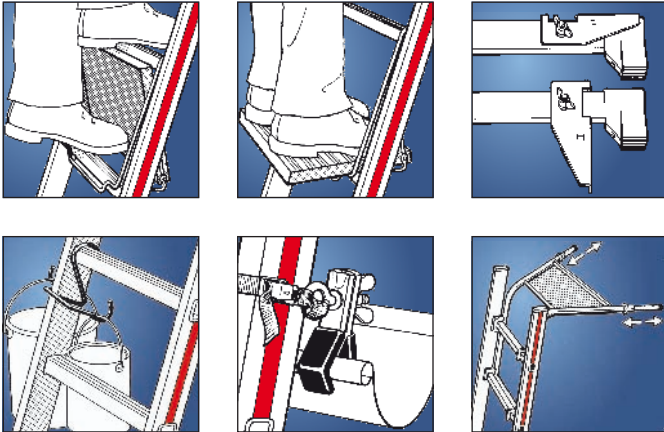

More accessories can be found from page 162 onwards.

**5 year  
guarantee**



**4045**

You will find further combination ladders on pages 17, 31, 32. **S**

Number of rungs		2x8	2x10	2x12
Stile	approx. mm	60	66	71
No. of rungs at max. extent		14	17	21
Length closed	approx. m	2.32	2.88	3.44
Length extended	approx. m	4.00	4.84	5.96
Standing ht, freestanding ladder	approx. m	1.52	2.05	2.58
Working ht, stepladder	approx. m	3.02	3.55	4.08
Reach ht, stepladder	approx. m	3.52	4.05	4.58
Standing ht, leaning ladder	approx. m	2.93	3.74	4.82
Working ht, ladder	approx. m	4.43	5.24	6.32
Reach ht, ladder	approx. m	4.93	5.74	6.82
Width top/bottom	approx. mm	2.19	2.72	3.24
Vertical ht, stepladder	approx. m	425/715	425/910	425/910
Weight	approx. kg	9.3	11.7	14.3
EAN code		4019502339101	4019502339118	4019502339125
Order no.		404516	404520	404524

For an explanation of working height/reach height in accordance with BGI 694, see page 10.

## Combination ladder, three-section 4047

- Combination freestanding ladder and extension ladder with 5 different possible uses:
  - freestanding ladder
  - freestanding ladder with extension section
  - leaning ladder (1, 2 or 3-section)
- High safety locking device with high-strength nylon straps.
- Safety bar easy to lock by hand (protected inside during transport).
- Firmly located stabiliser bar for high stability.
- German patent P 2942220.6 for strut locking.
- Internal width of ladder 300 mm (top section).
- Safe grip due to extra ribbing of the rungs.
- Ladder feet pressed into stile.
- Solid steel fittings.

**5 year guarantee**

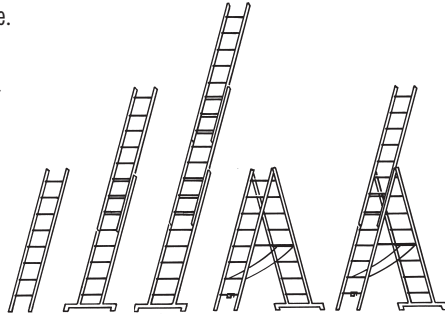

### Recommended accessories:

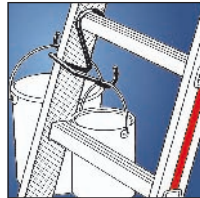
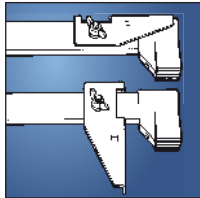

**4047**

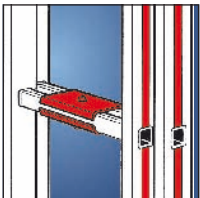
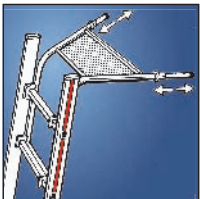
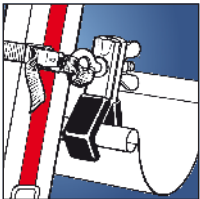

More accessories can be found from page 162 onwards. You will find further combination ladders on pages 16, 31, 32. **S**

Number of rungs		3x7	3x8	3x9	3x10	3x11	3x12	3x14
Stile	approx. mm	60/66	60/71	71/83	71/83	71/83	71/89	89
No. of rungs at max. extent		17	19	23	25	27	30	34
Length closed	approx. m	2.07	2.35	2.63	2.91	3.19	3.47	4.11
Length 3-section extended	approx. m	4.87	5.43	6.55	7.11	7.67	8.51	9.71
Standing ht, freestanding ladder	approx. m	2.07	2.59	3.12	3.64	3.91	4.43	5.22
Working ht, stepladder	approx. m	3.57	4.09	4.62	5.14	5.41	5.93	6.72
Reach ht, stepladder	approx. m	4.07	4.59	5.12	5.64	5.91	6.43	7.22
Standing ht, leaning ladder	approx. m	3.75	4.29	5.37	5.92	6.46	7.27	8.35
Working ht, ladder	approx. m	5.25	5.79	6.87	7.42	7.96	8.77	9.85
Reach ht, ladder	approx. m	5.75	6.29	7.37	7.92	8.46	9.27	10.35
Vert. ht, ladder + extension	approx. m	3.28	3.81	4.33	4.86	5.11	5.64	6.65
Width top/bottom	approx. mm	355/950	355/950	355/950	355/950	355/950	355/950	355/1065
Weight	approx. kg	13.8	14.7	17.4	20.0	22.1	26.0	30.5
EAN code		4019502339170	4019502339187	4019502339194	4019502339200	4019502339217	4019502339224	4019502339231
Order no.		404721	404724	404727	404730	404733	404736	404742

For an explanation of working height/reach height in accordance with BGI 694, see page 10.

## Telestep® telescopic ladder, four section 4042

- The Telestep is an extremely compact leaning ladder, freestanding ladder and stairway freestanding ladder with numerous functions.
- Low space requirements for storage and transport.
- Easy to use, thanks to the robust steel bracket hinge which automatically locks in any position and can be easily operated by thumb; With a press of the lever, the handy Telestep ladder package can thus easily be folded out for use as a leaning ladder or freestanding ladder or completely folded together again.
- Reliable locking devices made of plastic-coated steel; the required length can be easily obtained by pulling out the locking device and moving the ladder sections, with the HYMER Telestep, stable adjustment to uneven floor surfaces or steps is possible.



Steel bracket hinges for safe, non-trapping, fast operation

### Recommended accessories:

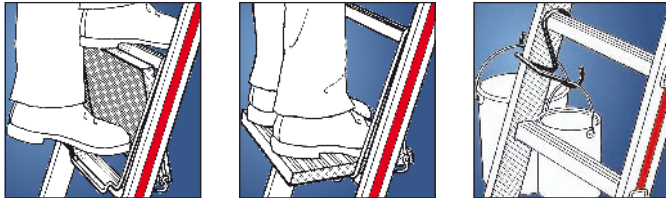

**Foot extension**  
adjustment range approximately 45 cm  
Order no. 0050302  
See also accessories on page 166.

More accessories can be found from page 162 onwards.



Length-adjustable leaning ladder

Height-adjustable freestanding ladder

Stairway freestanding ladder

5 year guarantee



4042

You will find further telescopic ladders on page 39.

S

Number of rungs	4x4	4x5	4x6
<b>Stile</b> approx. mm	60	60	60
<b>No. of rungs at max. extent</b>	14	18	22
<b>Length ladder</b> approx. m	2.35 - 4.02	2.90 - 5.14	3.46 - 6.26
<b>Vert. ht, stepladder</b> approx. m	1.15 - 1.95	1.40 - 2.49	1.70 - 3.03
<b>Standing ht, freestanding ladder</b> approx. m	1.26	1.80	2.35
<b>Working ht, stepladder</b> approx. m	2.76	3.30	3.85
<b>Reach ht, stepladder</b> approx. m	3.26	3.80	4.35
<b>Standing ht, leaning ladder</b> approx. m	3.00	4.10	5.20
<b>Working ht, ladder</b> approx. m	4.50	5.60	6.70
<b>Reach ht, ladder</b> approx. m	5.00	6.10	7.20
<b>Folded L x W x H</b> approx. m	1.20 x 0.55 x 0.20	1.50 x 0.65 x 0.20	1.80 x 0.70 x 0.20
<b>Weight</b> approx. kg	13.0	15.5	18.0
<b>EAN code</b>	4019502339385	4019502339392	4019502339408
<b>Order no.</b>	404216	404220	404224

For an explanation of working height/reach height in accordance with BGI 694, see page 10.

## Multipurpose ladder 4043

- Universal multipurpose ladder with six safety hinges, which automatically lock in every position.
- For use as a freestanding ladder, leaning ladder, work platform and stairway work platform (with boards for size 4x3).
- Rungs made of welded sheet aluminium.
- High-quality stable plastic rounded ladder feet pressed into stile.

Note: Only to be used as a working platform with a board.

**5 year  
guarantee**



**4043**



Steel bracket hinges for safe, non-trapping, fast operation

### Recommended accessories:

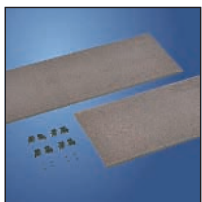
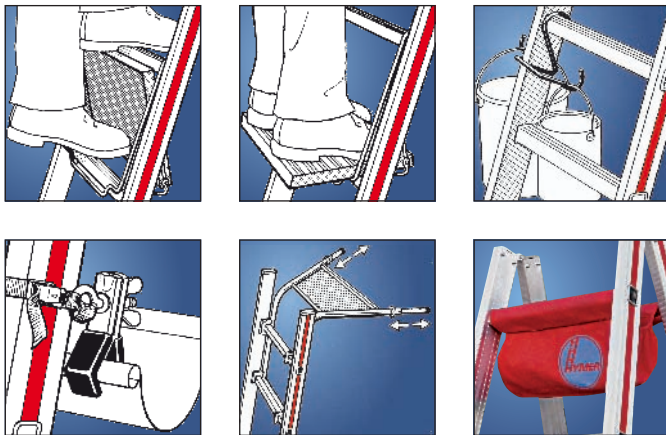

### Platform (board) for 4043

Order no. 0079639

See also accessories on page 169.

More accessories can be found from page 162 onwards.

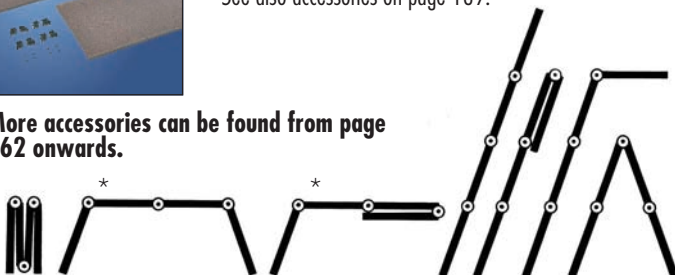

\* not permitted as work platform from size 4x4

**S**

Number of rungs		4x3	4x4	4x5
Stile	approx. mm	60	60	60
Length ladder	approx. m	3.47	4.59	5.71
Vertical ht, stepladder	approx. m	1.70	2.25	2.70
Working platf. L x H	approx. m	1.70 x 0.90	not permitted	not permitted
Standing ht, freestanding ladder	approx. m	1.15	1.70	2.25
Working ht, stepladder	approx. m	2.65	3.20	3.75
Reach ht. stepladder	approx. m	3.15	3.70	4.25
Standing ht, leaning ladder	approx. m	2.50	3.60	4.70
Working ht, ladder	approx. m	4.00	5.10	6.20
Reach ht, ladder	approx. m	4.50	5.60	6.70
Folded L x W x H	approx. m	0.90 x 0.70 x 0.30	1.20 x 0.80 x 0.30	1.50 x 1.00 x 0.30
Weight	approx. kg	12.4	14.6	16.8
EAN code		4019502339354	4019502339361	4019502339378
Order no.		404312	404316	404320

For an explanation of working height/reach height in accordance with BGI 694, see page 10.

## Double-sided freestanding rung ladder 4023

- Conical freestanding ladder.
- Stiles made of seamless extruded profiles with impact-resistant corner reinforcements and ergonomic shape.
- Rolled profile rungs.
- High-quality stable plastic rounded ladder feet pressed into stile.
- Safety locking device with high-strength, 20 mm wide nylon straps.

**5 year guarantee**

### Recommended accessories:

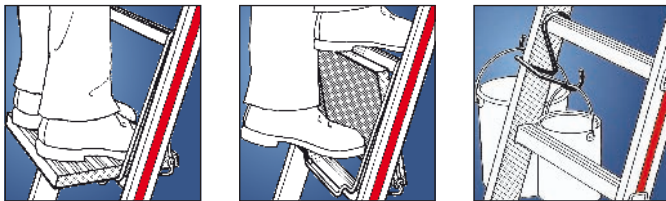

More accessories can be found from page 162 onwards.



**4023**

You will find further freestanding rung ladders on pages 21, 22, 33, 40.

Number of rungs		2x5	2x6	2x7	2x8	2x10	2x12	S
Stile	approx. mm	60	60	60	60	60	60	
Length	approx. m	1.47	1.75	2.05	2.33	2.88	3.44	
Vert. ht, stepladder	approx. m	1.45	1.70	1.95	2.25	2.75	3.25	
Standing height	approx. m	1.00	1.30	1.55	1.80	2.35	2.90	
Working height	approx. m	2.50	2.80	3.05	3.30	3.85	4.40	
Reach height	approx. m	3.00	3.30	3.55	3.80	4.35	4.90	
Width top/bottom	approx. mm	340/505	340/535	340/565	340/595	340/655	340/715	
Width between stiles	approx. m	0.95	1.15	1.25	1.45	1.85	2.05	
Weight	approx. kg	5.1	6.1	7.3	8.4	10.9	13.6	
EAN code		4019502339040	4019502339057	4019502339064	4019502339071	4019502339088	4019502339095	
Order no.		402310	402312	402314	402316	402320	402324	

For an explanation of working height/reach height in accordance with BGI 694, see page 10.



**0050376**

## 0050376 Universal foot extension set for freestanding rung ladder 4023

- Continuous adjustment up to 1000 mm.
- Numerous possible uses on all stairway types.
- Robust locking device.
- See also accessories on page 183.

German patent: 3806999

Only two extensions at one time permitted by industrial employers' liability insurance association.

Stile	approx. mm	60x24	S
Adjustment range	approx. mm	1.000	
EAN code		4019502316850	
Order no.		0050376	

## Stairway freestanding rung ladder 4123

- Conical double-sided freestanding ladder.
- Four infinitely adjustable foot extensions (2 x 100 cm, 2 x 37 cm), therefore various possible uses on all stairway types and uneven surfaces.
- Rolled profile rungs.
- High-quality stable plastic rounded ladder feet pressed into stile.

Attention: Always ascend and descend from the ladder section with the short extensions.

### Recommended accessories:

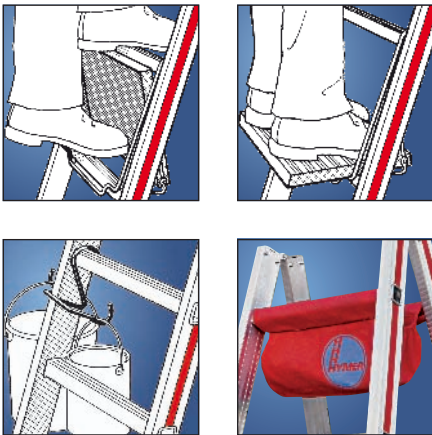

More accessories can be found from page 162 onwards.

5 year guarantee



4123

You will find further freestanding rung ladders on pages 20, 22, 33, 40.



### Spares for 4123:

#### Foot extension set

Order no. 0053440, length 1368 mm

Order no. 0053441, length 738 mm

0053440/0053441

	2x5	2x6	2x7	2x8
<b>Number of rungs</b>	2x5	2x6	2x7	2x8
<b>Stile</b>	approx. mm	60	60	60
<b>Length*</b>	approx. m	1.47	1.75	2.05
<b>Vert. ht, stepladder*</b>	approx. m	1.45	1.70	1.95
<b>Standing height*</b>	approx. m	1.10	1.35	1.65
<b>Working height*</b>	approx. m	2.60	2.85	3.15
<b>Reach height *</b>	approx. m	3.10	3.35	3.65
<b>Width top/bottom*</b>	approx. mm	340/505	340/535	340/565
<b>Width between stiles*</b>	approx. m	0.95	1.15	1.25
<b>Weight</b>	approx. kg	12.0	12.8	13.8
<b>EAN code</b>		4019502339286	4019502339293	4019502339309
<b>Order no.</b>		412310	412312	412314
				412316

\* Dimensions without foot extensions

For an explanation of working height/reach height in accordance with BGI 694, see page 10.

## Wooden freestanding rung ladder, double-sided 7-1410

- The wooden painter's ladder for tradespeople.
- Stiles made of soft wood or hard wood.
- Rungs made of stable beech.
- High-quality stile-rung connection with two-finger mortising.
- Anti-spread safety device made of high-strength red straps.

### Recommended accessories:



#### Ladder shoe

Order no. 007855  
See also accessories on page 170.

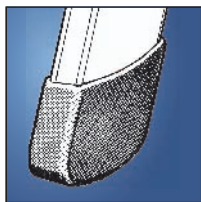

#### Foot extension

Order no. 0079640  
See also accessories on page 166.

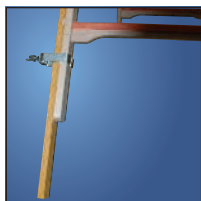

**5 year guarantee**



**7-1410**

More accessories can be found from page 162 onwards.

You will find further freestanding rung ladders on pages 20, 21, 33, 40.

**S**

<b>Number of rungs</b>		2x4	2x5	2x6	2x7	2x8	2x10	2x12
<b>Length</b>	<b>approx. m</b>	1.24	1.52	1.80	2.08	2.36	2.92	3.48
<b>Vert. ht, stepladder</b>	<b>approx. m</b>	1.18	1.45	1.70	2.00	2.25	2.75	3.30
<b>Standing height</b>	<b>approx. m</b>	0.80	1.10	1.35	1.65	1.90	2.45	3.00
<b>Working height</b>	<b>approx. m</b>	2.30	2.60	2.85	3.15	3.40	3.95	4.50
<b>Reach height</b>	<b>approx. m</b>	2.80	3.10	3.35	3.65	3.90	4.45	5.00
<b>Width between stiles</b>	<b>approx. m</b>	490	520	550	580	610	670	730
<b>Weight</b>	<b>approx. kg</b>	7.0	8.0	10.0	11.0	13.0	17.0	25.0
<b>EAN code</b>		4019502326217	4019502326224	4019502326231	4019502326248	4019502326255	4019502326279	4019502330849
<b>Order no.</b>		7141008	7141010	7141012	7141014	7141016	7141020	7141024

For an explanation of working height/reach height in accordance with BGI 694, see page 10.