

Rung leaning ladder 4011

- Ladder internal width 300 mm.
- Stiles made of seamless extruded profiles with ergonomic shape.
- Rolled profile rungs.
- High-quality plastic rounded ladder feet pressed into stile, protects wall surfaces on both sides, suitable for any application.

**5 year
guarantee**



Recommended accessories:

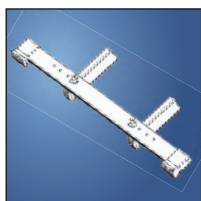
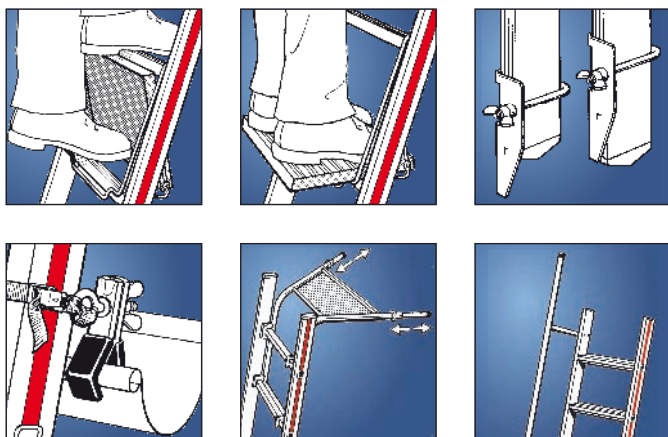

More accessories can be found from page 162 onwards.

You will find further rung leaning ladders on page 26.

S

Number of rungs		6	8	10	12	14	16	18
Stile	approx. mm	60	60	60	60	60	66	66
Length	approx. m	1.78	2.34	2.90	3.46	4.02	4.58	5.14
Standing height	approx. m	0.75	1.29	1.83	2.37	2.91	3.45	3.99
Working height	approx. m	2.24	2.79	3.33	3.87	4.41	4.95	5.49
Reach height	approx. m	2.75	3.29	3.83	4.37	4.91	5.45	5.99
Width	approx. mm	355	355	355	355	355	355	355
Weight	approx. kg	2.9	3.7	4.6	5.5	6.4	7.7	8.4
EAN code		4019502338975	4019502338982	4019502338999	4019502339002	4019502339019	4019502339026	4019502339033
Order no.		401106	401108	401110	401112	401114	401116	401118

For an explanation of working height/reach height in accordance with BGI 694, see page 10.

Extension ladder, two-section 4046

- Ladder internal width 300 mm.
- Stiles made of seamless extruded profiles with ergonomic shape.
- Rungs made of welded sheet aluminium.
- High-quality absolutely stable plastic rounded ladder feet pressed into stile.
- Guide fittings made of solid steel.
- The two ladder sections can be used individually and offer numerous possible uses, including as separate leaning ladders.

**5 year
guarantee**



Recommended accessories:

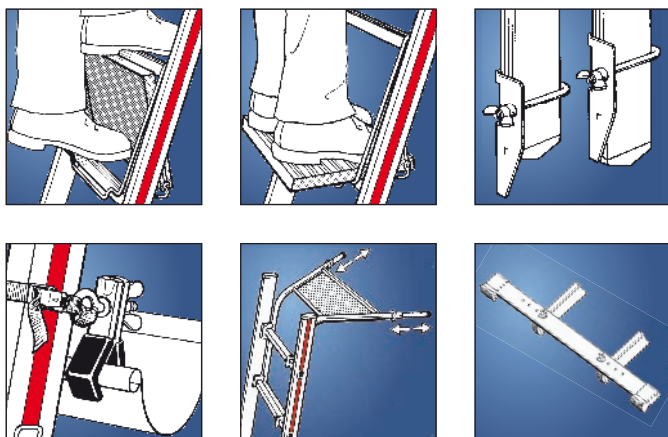

More accessories can be found from page 162 onwards.

You will find further extension ladders on page 27.

S

Number of rungs		2x10	2x12	2x14	2x16
Stile	approx. mm	66	71	83	83
No. of rungs at max. extent		17	21	25	29
Length closed	approx. m	2.90	3.46	4.02	4.58
Length extended	approx. m	4.86	5.98	7.10	8.22
Standing height	approx. m	3.74	4.82	5.90	6.98
Working height	approx. m	5.24	6.32	7.40	8.48
Reach height	approx. m	5.74	6.82	7.90	8.98
Width top/bottom	approx. mm	355/425	355/425	355/425	355/425
Weight	approx. kg	10.2	14.0	16.5	20.6
EAN code		4019502339132	4019502339149	4019502339156	4019502339163
Order no.		404620	404624	404628	404632

For an explanation of working height/reach height in accordance with BGI 694, see page 10.

Rope-operated extension ladder, two-section 4051

- Stiles made of seamless extruded profiles with ergonomic shape.
- Rolled profile rungs.
- High-quality absolutely stable plastic rounded ladder feet pressed into stile.
- Guide fittings made of solid steel.
- Automatically locking fall hook with gravity locking.
- Wall wheels made of protective plastic at the top end of the ladder.
- Internal width of ladder 300 mm (top section).
- Non-slip rope (10 mm), for safe height adjustment.

5 year guarantee



4051

Recommended accessories:

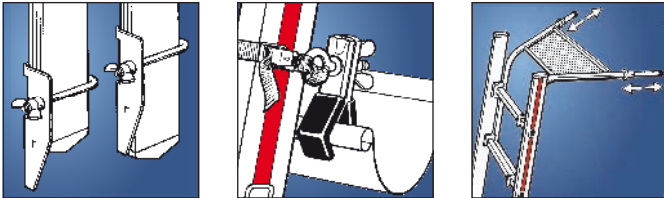

More accessories can be found from page 162 onwards.

You will find further rope operated ladders on pages 15, 28, 29.

S

Number of rungs		2x14	2x16	2x18	2x20
Stile	approx. mm	83	89	89	89
No. of rungs at at max. extent		25	29	32	36
Length closed	approx. m	4.11	4.67	5.23	5.79
Length extended	approx. m	7.18	8.30	9.14	10.26
Standing height	approx. m	5.97	7.05	7.86	8.95
Working height	approx. m	7.47	8.55	9.36	10.45
Reach height	approx. m	7.97	9.05	9.86	10.95
Width top/bottom	approx. mm	355/425	355/425	355/425	355/425
Weight	approx. kg	20.0	22.5	25.5	29.4
EAN code		4019502339248	4019502339255	4019502339262	4019502339279
Order no.		405128	405132	405136	405140

For an explanation of working height/reach height in accordance with BGI 694, see page 10.

Rope-operated extension ladder, three-section 4061

- Stiles made of seamless extruded profiles with ergonomic shape.
- Rolled profile rungs.
- High-quality absolutely stable plastic rounded ladder feet pressed into stile.
- Guide fittings made of solid steel.
- Wall wheels made of protective plastic at the top end of the ladder.
- Internal width of ladder 300 mm (top section).
- Automatically locking fall hook with gravity locking.
- High-strength, non-slip rope in different colours to distinguish:
 - upper section rope colour orange, 10 mm
 - middle section rope colour blue, 10 mm

The middle section must be extended at least two rungs before the ladder is fully extended.

Recommended accessories:

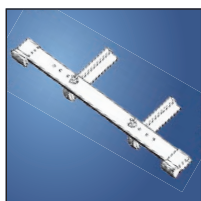
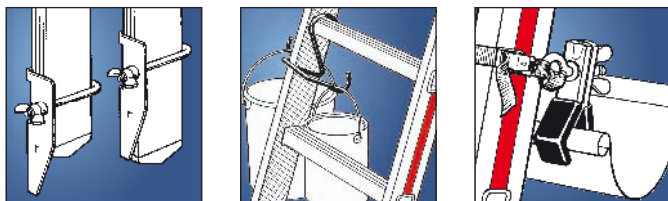

More accessories can be found from page 162 onwards.

5 year guarantee



4061

You will find further rope operated ladders on pages 14, 28, 29.

S

Number of rungs		3x12	3x14	3x16
Stile	approx. mm	83/89	89	89/100
No. of rungs at max. extent		29	34	40
Length closed	approx. m	3.57	4.13	4.69
Length extended	approx. m	8.33	9.76	11.44
Standing height	approx. m	7.02	8.37	10.00
Working height	approx. m	8.52	9.87	11.50
Reach height	approx. m	9.02	10.37	12.00
Width top/bottom	approx. mm	355/425/490	355/425/490	355/425/490
Weight	approx. kg	28.5	33.0	39.0
EAN code		4019502339323	4019502339330	4019502339347
Order no.		406136	406142	406148

For an explanation of working height/reach height in accordance with BGI 694, see page 10.